

# STUDIOBUILT

## Cabinetry

### Frameless Cabinetry Specifications

- 1 Box Construction**  
¾" thick wood based composite panel with TFL 2S. All cabinet interiors are white. Front edgebanding is white or black PVC, bonded with PUR adhesive. Full ¾" back panel is rabbeted for rigidity and strength. Toe kicks and top rail are glued and doweled.
- 2 End Panels**  
¾" thick wood based composite panel with TFL 2S. Front edgebanding is white or black PVC, bonded with PUR adhesive. The toe notch is integrated.
- 3 Top and Bottom Panels**  
¾" thick wood-based composite panel with TFL 2S. Bottoms are glued and doweled to sides. Front edgebanding is white or black PVC, bonded with PUR adhesive.
- 4 Back Panel**  
¾" thick wood-based composite panel with TFL 2S. Solid back panels are rabbeted and glued to case sides and bottom.
- 5 Shelves**  
¾" thick wood-based composite panel with TFL 2S. Front edgebanding is white or black PVC, bonded with PUR adhesive. Shelves are adjustable in all cabinets. Wall cabinets and tall cabinets have full depth shelves. Base and vanity cabinets have 2/3 depth shelves.
- 6 Toe Kick**  
¾" thick wood-based composite panel with TFL 2S. 4 - 1/4"h x 3" d wood-based composite panel captured between end panels.
- 7 Top Rails and Drawer Rails**  
¾" thick wood-based composite panel with TFL 2S. Edgebanding is white or black PVC, bonded with PUR adhesive.

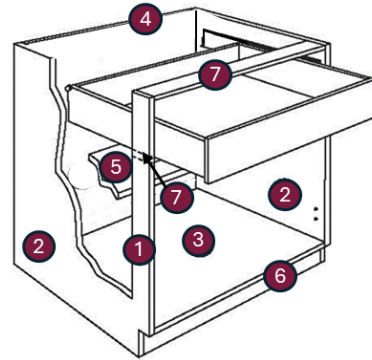
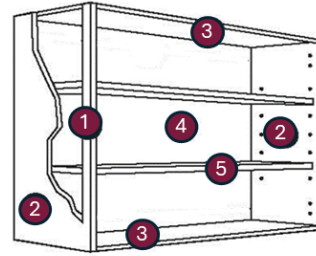

### Drawers

#### **Standard: White Metal Drawer**

The drawer box is soft-close, ¾ extension, single wall, steel construction. Integrated drawer slide and drawer side with white baked-on epoxy finish. Load capacity of 75 lbs. Drawer bottoms and backs are ¾" thick wood-based composite panel with white laminate on both faces and matching edge band on top edge.

#### **Upgrade: Dovetail Drawer**

Front, back and sides are nominal 5/8" thick hardwood with dovetail construction with natural U.V. finish. Drawer bottoms are nominal 1/4" thick multi-ply hardwood plywood inserted into dado in front, back and sides. Includes high-quality steel, undermount soft-close drawer guides with two-way adjustment. Load Rating is 75 lb capacity.

### Hinges

**Standard:** Soft-close, full overlay concealed 3-way adjustable hinge with self-closing feature.

#### **Cabinet Box Option:**

**Upgraded:** 18mm Plywood, TFL finish 2S

© Rosario Cabinets, Inc. 2024 RCI reserves the right to  
amend product specifications.

