

STUDIOBUILT

Cabinetry

Frameless Cabinetry Specifications

- 1 Box Construction**
¾" thick wood based composite panel with TFL 2S. All cabinet interiors are white. Front edgebanding is white or black PVC, bonded with PUR adhesive. Full ¾" back panel is rabbeted for rigidity and strength. Toe kicks and top rail are glued and doweled.
- 2 End Panels**
¾" thick wood based composite panel with TFL 2S. Front edgebanding is white or black PVC, bonded with PUR adhesive. The toe notch is integrated.
- 3 Top and Bottom Panels**
¾" thick wood-based composite panel with TFL 2S. Bottoms are glued and doweled to sides. Front edgebanding is white or black PVC, bonded with PUR adhesive.
- 4 Back Panel**
¾" thick wood-based composite panel with TFL 2S. Solid back panels are rabbeted and glued to case sides and bottom.
- 5 Shelves**
¾" thick wood-based composite panel with TFL 2S. Front edgebanding is white or black PVC, bonded with PUR adhesive. Shelves are adjustable in all cabinets. Wall cabinets and tall cabinets have full depth shelves. Base and vanity cabinets have 2/3 depth shelves.
- 6 Toe Kick**
¾" thick wood-based composite panel with TFL 2S. 4 - 1/4" h x 3" d wood-based composite panel captured between end panels.
- 7 Top Rails and Drawer Rails**
¾" thick wood-based composite panel with TFL 2S. Edgebanding is white or black PVC, bonded with PUR adhesive.

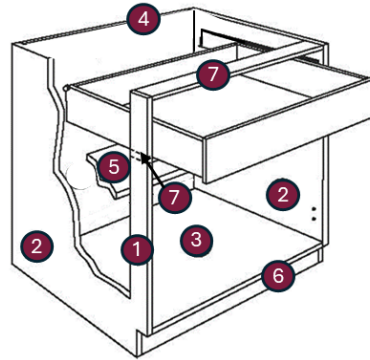
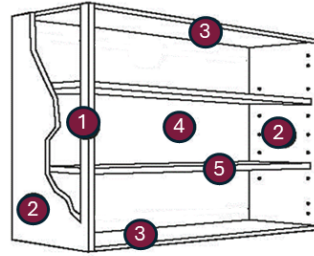

Drawers

Standard: White TFL Drawer Box

Four-sided 5/8" thick TFL 2S, with 1mm matching edgebanding on top edges. Dowel construction for durability and performance.

Hinges

Standard: Soft-close, full overlay concealed 3-way adjustable hinge with self-closing feature.

Drawer Glides

Standard: Soft-close, full extension, 100-pound rating, 6-way adjustable



©StudioBuilt Cabinetry 2025