

Main Street Closet...the intersection of versatility, simplicity, durability and value...

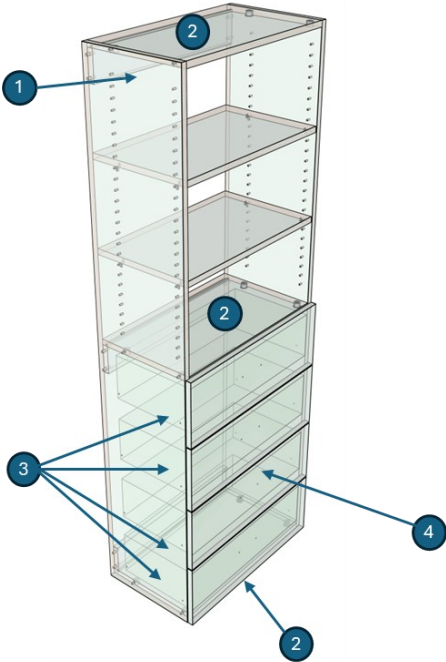

1 ¾" TFL, 2-sided on sides, tops, bottoms, shelves, hanging rails, and drawer fronts. 1mm edgebanding on all visible edges, bonded with EVA hotmelt adhesive.

3 Drawer Boxes: 5/8" TFL, 2-sided TFL with 1mm edgeband, bonded with EVA hotmelt adhesive. ¼" thick TFL drawer bottom.

2 ¾" TFL, 2-sided, drop-in, top, bottom and fixed shelf for easy on-site assembly. 1mm edgebanding on all visible edges, bonded with EVA hotmelt adhesive.

4 5-piece Drawer Box: 5/8" 2-sided TFL with 1mm edgeband, bonded with EVA hotmelt adhesive. RTA construction. ¾ extension, undermount glides.

